

**2 WEEKS PRIOR**

FRAME 1	FRAME 2
COULSON ST	VISIT
CLOSURE	LIVE TRAFFIC
28-31 JULY	.COM

**DURING CLOSURE**

FRAME 1	FRAME 2
COULSON ST	DETOUR
CLOSED	SYDNEY PARK
NO ACCESS	ROAD



**2 WEEKS PRIOR**

FRAME 1	FRAME 2
COULSON ST	VISIT
CLOSURE	LIVE TRAFFIC
28-31 JULY	.COM

**DURING CLOSURE**

FRAME 1	FRAME 2
COULSON ST	DETOUR
CLOSED	SYDNEY PARK
NO ACCESS	ROAD

<b>CLIENT CONTACT:</b> JOHN HOLLAND RAIL KRISHNA KUMAR 400 357 054	<b>WORKS LOCATION:</b> COULSON ST, ERSKENVILLE	<b>DRAWING NUMBER:</b> 23-06-1122095	<b>WORKSITE REQUIREMENTS:</b> TRAFFIC CONTROLLERS : 9 TRAFFIC MANAGERS - BREAKS : 1 SIGNAGE VEHICLES : 4	<b>APPROVED FOR IMPLEMENTATION</b> <small>WHEN USED WITH ROAD AUTHORITY APPROVAL</small>	<b>NOT TO SCALE PRINT A3</b>
	<b>WORKSITE ROAD AUTHORITY:</b> CITY OF SYDNEY	<b>ESTIMATED JOB DATE:</b> 28/07 - 31/07/2023	<b>GENERAL DISCLAIMER:</b> THE TSDMP HAS BEEN PREPARED IN ACCORDANCE WITH THE INFORMATION SUPPLIED BY ALL STAKEHOLDERS. TECHNICAL USER CARE HAS BEEN APPLIED IN THE COLLATION OF THE RELEVANT INFORMATION ON WHICH THIS TSDMP IS BASED. JOHN HOLLAND RAIL IS RESPONSIBLE FOR UNDERTAKING AN EVALUATION OF THE SITE AND TRAFFIC CONDITIONS AGAINST THE ON-SITE APPLICATION CONSTRAINTS OUTLINED WITHIN THIS TSDMP. THESE CONDITIONS VARY FROM THOSE DOCUMENTED. ADDITIONAL INPUT FROM A TM DESIGN PROFESSIONAL SHALL BE OBTAIN PRIOR TO IMPLEMENTATION. DAILY RECORD KEEPING SHALL BE PERFORMED, INCLUDING RELEVANT SITE INSPECTIONS, DURING WORKS. THIS TSDMP SHALL REMAIN VALID FOR 12 MONTHS FROM THE DESIGN DATE OR WHERE STATE SPECIFIC COVERAGE IS CHANGED AT THIS POINT THE TSDMP WILL NEED TO BE REVISED ON CURRENCY OF COMPLIANCE.	<b>SPECIALIST VEHICLE REQUIREMENTS:</b> VMS UTE : 0 TMA : 0 DDV : 2 POLICE : 0	DESIGNED BY: A KELLY TCT0006840
<b>ESTIMATED JOB TIME:</b> DAY AND NIGHT WORKS WEDNESDAY	<b>GARBAGE COLLECTION DAY:</b>	<b>DATE OF DESIGN:</b> 16/06/2023	<b>DEVICE REQUIREMENTS:</b> TOTAL CONES : 70 PTCO : 0 1.8m STOP BATS : 0 TOTAL SIGNS : 0 THMS : 0 RADIOS : 10 PTAB : 0 VMS TRAILER : 6	DESIGNED REVIEW: B WIFFEN TCT0100517	<b>APPROVAL DATE:</b> 16/06/2023 <b>ALTUS NOMINATED CONTACT:</b> 24Hr Contact - 1300 872 334 <b>SHEET NO:</b> 6 OF 7

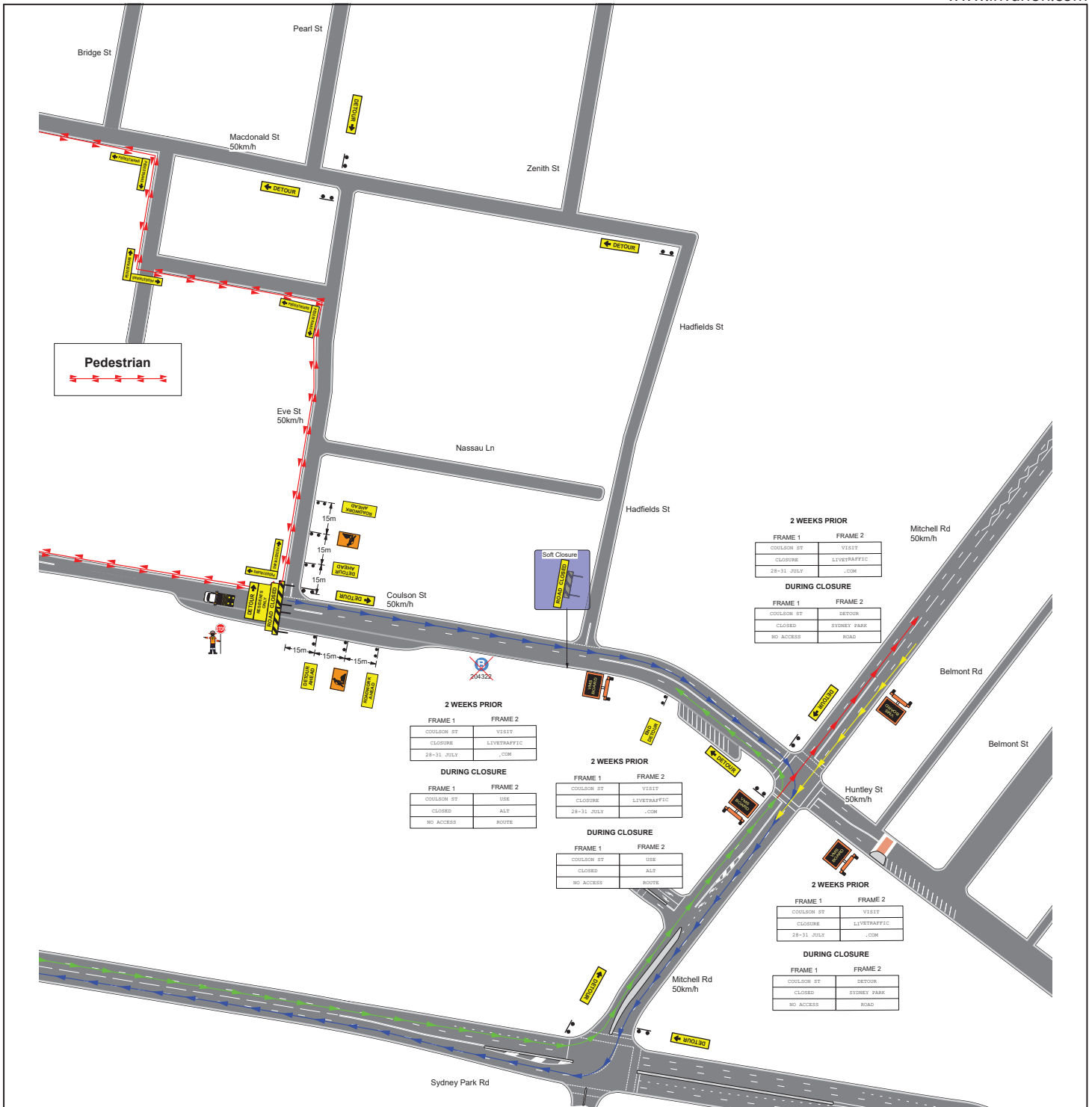

**2 WEEKS PRIOR**

FRAME 1	FRAME 2
COULLSON ST VISIT	
CLOSURE	LIVETRAFFIC
28-31 JULY	.COM

**DURING CLOSURE**

FRAME 1	FRAME 2
COULLSON ST	DETOUR
CLOSED	STREET PARK
NO ACCESS	ROAD

**2 WEEKS PRIOR**

FRAME 1	FRAME 2
COULLSON ST	VISIT
CLOSURE	LIVETRAFFIC
28-31 JULY	.COM

**DURING CLOSURE**

FRAME 1	FRAME 2
COULLSON ST	USE
CLOSED	ALT
NO ACCESS	ROUTE

**2 WEEKS PRIOR**

FRAME 1	FRAME 2
COULLSON ST	VISIT
CLOSURE	LIVETRAFFIC
28-31 JULY	.COM

**DURING CLOSURE**

FRAME 1	FRAME 2
COULLSON ST	USE
CLOSED	ALT
NO ACCESS	ROUTE

**2 WEEKS PRIOR**

FRAME 1	FRAME 2
COULLSON ST	VISIT
CLOSURE	LIVETRAFFIC
28-31 JULY	.COM

**DURING CLOSURE**

FRAME 1	FRAME 2
COULLSON ST	DETOUR
CLOSED	STREET PARK
NO ACCESS	ROAD

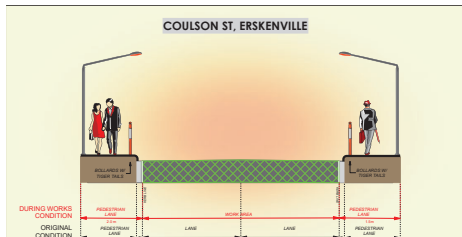

**COULLSON ST, ERSKENVILLE**

CLIENT CONTACT: JOHN HOLLAND RAIL, KRISHNA KUMAR, 400 387 654

WORKS LOCATION: COULLSON ST, ERSKENVILLE

BETWEEN ROADS: FLORA ST AND EVE ST

WORKSITE ROAD AUTHORITY: CITY OF SYDNEY

ESTIMATED JOB DATE: 28/07 - 31/07/2023

ESTIMATED JOB TIME: DAY AND NIGHT WORKS

GARBAGE COLLECTION DAY: WEDNESDAY

DATE OF DESIGN: 16/06/2023

DRAFTER INITIAL: MC

DRAFTER PEER REVIEW: N/A

ISSUE	DESG	DATE	AMENDMENT DESCRIPTION
A			
B			
C			

**DRAWING NUMBER: 23-06-1122095**

**GENERAL DISCLAIMER:**

THE TOSTMP HAS BEEN PREPARED IN ACCORDANCE WITH THE INFORMATION SUPPLIED BY ALL STAKEHOLDERS.

TECHNICAL USER CARE HAS BEEN APPLIED IN THE COLLATION OF THE RELEVANT INFORMATION ON WHICH THIS USER CARE IS BASED.

TRAFFIC AND SITE CONDITIONS AT THE TIME OF THE WORKS MAY VARY FROM THOSE ESTABLISHED AT THE POINT OF DESIGN.

JOHN HOLLAND RAIL IS RESPONSIBLE FOR UNDERSTANDING AN EVALUATION OF THE SITE AND TRAFFIC CONDITIONS AGAINST THE ON SITE APPLICATION CONSTRAINTS OUTLINED WITHIN THE TOSTMP.

WORKING CONDITIONS VARY FROM THOSE DOCUMENTED, ADDITIONAL INPUT FROM A TM DESIGN PROFESSIONAL SHALL BE OBTAINED PRIOR TO IMPLEMENTATION.

DAILY RECORD KEEPING SHALL BE PERFORMED INCLUDING RELEVANT SITE INSPECTIONS, DURING WORKS.

THIS TOSTMP SHALL REMAIN VALID FOR 12 MONTHS FROM THE DESIGN DATE OR WHERE STATE SPECIFIC COVERAGE IS CHANGED, AT THIS POINT THE TOSTMP WILL NEED TO BE REVIEWED ON CURRENCY OF COMPLIANCE.

**WORKSITE REQUIREMENTS:**

TRAFFIC CONTROLLERS : 9

TRAFFIC MANAGERS - BREAKS : 1

SHOWAGE VEHICLES : 4

**SPECIALIST VEHICLE REQUIREMENTS:**

VMS UTE : 0 TMA : 0 DDV : 2 POLICE : 0

**DEVICE REQUIREMENTS:**

TOTAL CONES : 70

PTCD : 0

1.8m STOP BATS : 0

TOTAL SIGNS : 0

THMS : 0

RADIOS : 10

PTAB : 0

VMS TRAILER : 6

**APPROVED FOR IMPLEMENTATION**

DESIGNED BY: A KELLY TCT0006840

DESIGNED REVIEW: B WIFFEN TCT0100517

APPROVAL DATE: 16/06/2023

ALTUS NOMINATED CONTACT: 24hr Contact - 1300 872 334

SHEET NO: 7 OF 7

**NOT TO SCALE PRINT A3**

Call Altus Traffic  
508 FIVE (MARRS)  
1300 TRAFFIC  
872 334  
AS/NZS 84:102 788 061 800.000k 90.000k 90.000k